

# CJSX



Motor fuera del paso del aire

## Unidades de extracción 400°C/2h, a transmisión con ventilador de simple aspiración

Unidades de extracción 400°C/2h, con motor fuera del paso del aire, para trabajar en el exterior de la zona de riesgo de incendios

### Ventilador:

- Estructura en chapa de acero galvanizado
- Turbina con álabes hacia delante, en chapa de acero galvanizado
- Homologación según norma EN-12101-3-2002, con certificación Nº: 0370-CPD-0503

### Motor:

- Motores clase F, con rodamientos a bolas, protección IP55
- Trifásicos 230/400V.-50Hz.(hasta 5,5CV) y 400/690V.-50Hz.(potencias superiores a 5,5CV)
- Temperatura máxima del aire a transportar: Servicio S1 -20°C+ 120°C en continuo, Servicio S2 200°C/2h, 300°C/2h y 400°C/2h

### Acabado:

- Anticorrosivo en chapa de acero galvanizado

### Bajo demanda:

- Extractores con motor de 2 velocidades
- Extractores con salida vertical



## Código de pedido

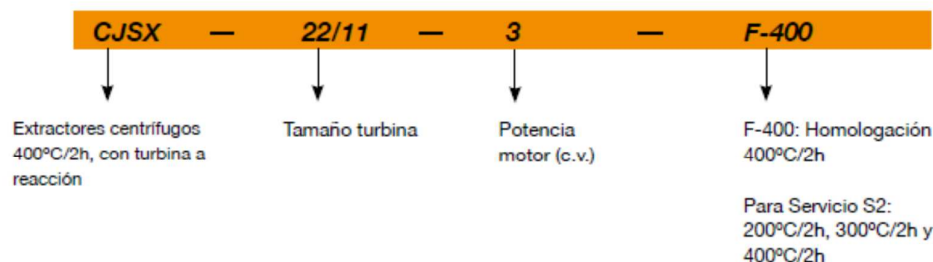

## Características técnicas

| Modelo         | Velocidad<br>(r/min) | Intensidad máxima admisible (A) |             |      | Potencia<br>instalada<br>(kW) | Caudal<br>máximo<br>(m³/h) | Nivel presión<br>sonora<br>dB(A) | Peso aprox.<br>(Kg) |
|----------------|----------------------|---------------------------------|-------------|------|-------------------------------|----------------------------|----------------------------------|---------------------|
|                |                      | 230V                            | 400V<br>(A) | 690V |                               |                            |                                  |                     |
| CJSX-12/6-0,75 | 1000                 | 2,42                            | 1,40        |      | 0,55                          | 2600                       | 69                               | 73                  |
| CJSX-12/6-1    | 1100                 | 3,29                            | 1,90        |      | 0,75                          | 3100                       | 71                               | 74                  |
| CJSX-12/6-1,5  | 1250                 | 4,49                            | 2,59        |      | 1,10                          | 3500                       | 74                               | 77                  |
| CJSX-12/6-2    | 1300                 | 5,98                            | 3,45        |      | 1,50                          | 4250                       | 77                               | 80                  |
| CJSX-12/6-3    | 1500                 | 8,31                            | 4,80        |      | 2,20                          | 4800                       | 79                               | 85                  |
| CJSX-15/7-1    | 800                  | 3,29                            | 1,90        |      | 0,75                          | 4000                       | 67                               | 92                  |
| CJSX-15/7-1,5  | 850                  | 4,49                            | 2,59        |      | 1,10                          | 4800                       | 69                               | 95                  |
| CJSX-15/7-2    | 920                  | 5,98                            | 3,45        |      | 1,50                          | 5400                       | 72                               | 98                  |
| CJSX-15/7-3    | 1000                 | 8,31                            | 4,80        |      | 2,20                          | 6400                       | 75                               | 103                 |
| CJSX-15/7-4    | 1050                 | 11,22                           | 6,48        |      | 3,00                          | 7400                       | 77                               | 106                 |
| CJSX-18/9-1,5  | 750                  | 4,49                            | 2,59        |      | 1,10                          | 5800                       | 68                               | 111                 |
| CJSX-18/9-2    | 790                  | 5,98                            | 3,45        |      | 1,50                          | 6600                       | 70                               | 114                 |
| CJSX-18/9-3    | 800                  | 8,31                            | 4,80        |      | 2,20                          | 8200                       | 74                               | 119                 |
| CJSX-18/9-4    | 850                  | 11,22                           | 6,48        |      | 3,00                          | 9000                       | 76                               | 122                 |
| CJSX-18/9-5,5  | 920                  | 14,90                           | 8,60        |      | 4,00                          | 10500                      | 78                               | 125                 |
| CJSX-20/10-2   | 650                  | 5,98                            | 3,45        |      | 1,50                          | 8100                       | 65                               | 203                 |
| CJSX-20/10-3   | 690                  | 8,31                            | 4,80        |      | 2,20                          | 10100                      | 68                               | 208                 |
| CJSX-20/10-4   | 750                  | 11,22                           | 6,48        |      | 3,00                          | 11500                      | 70                               | 211                 |
| CJSX-20/10-5,5 | 790                  | 14,90                           | 8,60        |      | 4,00                          | 13100                      | 73                               | 214                 |

## Características técnicas

| Modelo          | Velocidad<br>(r/min) | Intensidad máxima admisible (A) |          |       | Potencia instalada<br>(kW) | Caudal máximo<br>(m³/h) | Nivel presión sonora<br>dB(A) | Peso aprox.<br>(Kg) |
|-----------------|----------------------|---------------------------------|----------|-------|----------------------------|-------------------------|-------------------------------|---------------------|
|                 |                      | 230V                            | 400V (A) | 690V  |                            |                         |                               |                     |
| CJSX-20/10-7,5  | 850                  |                                 | 11,10    | 6,40  | 5,50                       | 15000                   | 75                            | 227                 |
| CJSX-22/11-3    | 580                  | 8,31                            | 4,80     |       | 2,20                       | 11200                   | 67                            | 219                 |
| CJSX-22/11-4    | 610                  | 11,22                           | 6,48     |       | 3,00                       | 13000                   | 70                            | 222                 |
| CJSX-22/11-5,5  | 650                  | 14,90                           | 8,60     |       | 4,00                       | 15000                   | 72                            | 225                 |
| CJSX-22/11-7,5  | 690                  |                                 | 11,10    | 6,40  | 5,50                       | 17000                   | 74                            | 238                 |
| CJSX-22/11-10   | 750                  |                                 | 14,80    | 8,50  | 7,50                       | 19000                   | 76                            | 246                 |
| CJSX-22/11-12,5 | 790                  |                                 | 17,80    | 10,30 | 9,20                       | 21000                   | 78                            | 257                 |
| CJSX-22/11-15   | 830                  |                                 | 21,50    | 12,40 | 11,00                      | 22000                   | 79                            | 273                 |
| CJSX-22/11-20   | 910                  |                                 | 28,50    | 16,50 | 15,00                      | 24500                   | 81                            | 292                 |
| CJSX-22/11-25   | 1000                 |                                 | 35,00    | 20,20 | 18,50                      | 26000                   | 83                            | 322                 |
| CJSX-25/13-4    | 520                  | 11,22                           | 6,48     |       | 3,00                       | 14000                   | 62                            | 254                 |
| CJSX-25/13-5,5  | 550                  | 14,90                           | 8,60     |       | 4,00                       | 17000                   | 65                            | 257                 |
| CJSX-25/13-7,5  | 590                  |                                 | 11,10    | 6,40  | 5,50                       | 19500                   | 67                            | 270                 |
| CJSX-25/13-10   | 620                  |                                 | 14,80    | 8,50  | 7,50                       | 23000                   | 70                            | 278                 |
| CJSX-25/13-12,5 | 650                  |                                 | 17,80    | 10,30 | 9,20                       | 25000                   | 72                            | 289                 |
| CJSX-25/13-15   | 690                  |                                 | 21,50    | 12,40 | 11,00                      | 26500                   | 74                            | 305                 |
| CJSX-25/13-20   | 750                  |                                 | 28,50    | 16,50 | 15,00                      | 29500                   | 75                            | 324                 |
| CJSX-25/13-25   | 810                  |                                 | 35,00    | 20,20 | 18,50                      | 32000                   | 77                            | 354                 |
| CJSX-30/14-5,5  | 400                  | 14,90                           | 8,60     |       | 4,00                       | 21000                   | 69                            | 331                 |
| CJSX-30/14-7,5  | 425                  |                                 | 11,10    | 6,40  | 5,50                       | 24000                   | 72                            | 344                 |
| CJSX-30/14-10   | 460                  |                                 | 14,80    | 8,50  | 7,50                       | 27500                   | 74                            | 352                 |
| CJSX-30/14-12,5 | 480                  |                                 | 17,80    | 10,30 | 9,20                       | 30000                   | 76                            | 363                 |
| CJSX-30/14-15   | 500                  |                                 | 21,50    | 12,40 | 11,00                      | 33000                   | 77                            | 379                 |
| CJSX-30/14-20   | 550                  |                                 | 28,50    | 16,50 | 15,00                      | 36500                   | 78                            | 398                 |
| CJSX-30/14-25   | 600                  |                                 | 35,00    | 20,20 | 18,50                      | 38000                   | 81                            | 428                 |

## Dimensiones mm

Suministro standard impulsión horizontal (H) RD-90

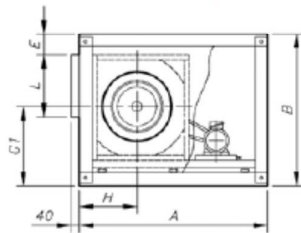

Bajo demanda impulsión vertical (V) RD-90

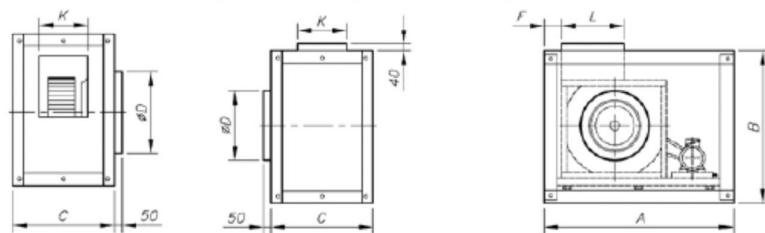

Bajo demanda impulsión horizontal (H) LG-90

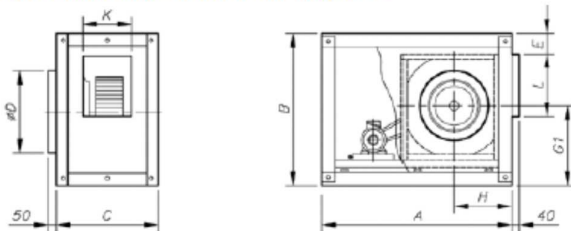

Bajo demanda impulsión vertical (V) LG-90

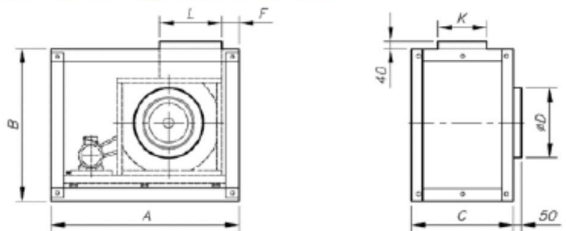

| Modelo       | A    | B    | C   | ØD  | E   | con bancada |    | GI  | con bancada |     | H   | con bancada |     | K |
|--------------|------|------|-----|-----|-----|-------------|----|-----|-------------|-----|-----|-------------|-----|---|
|              |      |      |     |     |     | E           | F  |     | GI          | L   |     |             |     |   |
| CJSX-12/6-H  | 850  | 650  | 540 | 330 | 74  | -           | -  | 288 | -           | 288 | 346 | -           | 210 |   |
| CJSX-12/6-V  | 850  | 650  | 540 | 330 | -   | -           | 30 | 318 | -           | 328 | 346 | -           | 210 |   |
| CJSX-15/7-H  | 1000 | 755  | 600 | 400 | 74  | -           | -  | 328 | -           | 328 | 411 | -           | 270 |   |
| CJSX-15/7-V  | 1000 | 755  | 600 | 400 | -   | -           | 30 | 378 | -           | 383 | 411 | -           | 270 |   |
| CJSX-18/9-H  | 1200 | 875  | 620 | 480 | 74  | -           | -  | 383 | -           | 388 | 491 | -           | 305 |   |
| CJSX-18/9-V  | 1200 | 875  | 620 | 480 | -   | -           | 30 | 433 | -           | 448 | 491 | -           | 305 |   |
| CJSX-20/10-H | 1485 | 1175 | 730 | 565 | 175 | 120         | -  | 475 | 530         | 440 | 613 | 605         | 343 |   |
| CJSX-20/10-V | 1485 | 1175 | 730 | 565 | -   | -           | 75 | 535 | -           | 585 | 613 | -           | 343 |   |
| CJSX-22/11-H | 1570 | 1250 | 760 | 615 | 165 | 110         | -  | 510 | 565         | 470 | 708 | 700         | 373 |   |
| CJSX-22/11-V | 1570 | 1250 | 760 | 615 | -   | -           | 75 | 570 | -           | 640 | 708 | -           | 373 |   |
| CJSX-25/13-H | 1610 | 1375 | 820 | 685 | 175 | 120         | -  | 550 | 605         | 495 | 803 | 795         | 423 |   |
| CJSX-25/13-V | 1610 | 1375 | 820 | 685 | -   | -           | 75 | 625 | -           | 705 | 803 | -           | 423 |   |
| CJSX-30/14-H | 1845 | 1600 | 855 | 820 | 160 | 95          | -  | 655 | 710         | 580 | 943 | 935         | 488 |   |
| CJSX-30/14-V | 1845 | 1600 | 855 | 820 | -   | -           | 75 | 760 | -           | 825 | 943 | -           | 488 |   |

**Curvas características**

Q= Caudal en m<sup>3</sup>/h, m<sup>3</sup>/s y cfm.

Pe= Presión estática en mm.c.a., Pa e inwg.

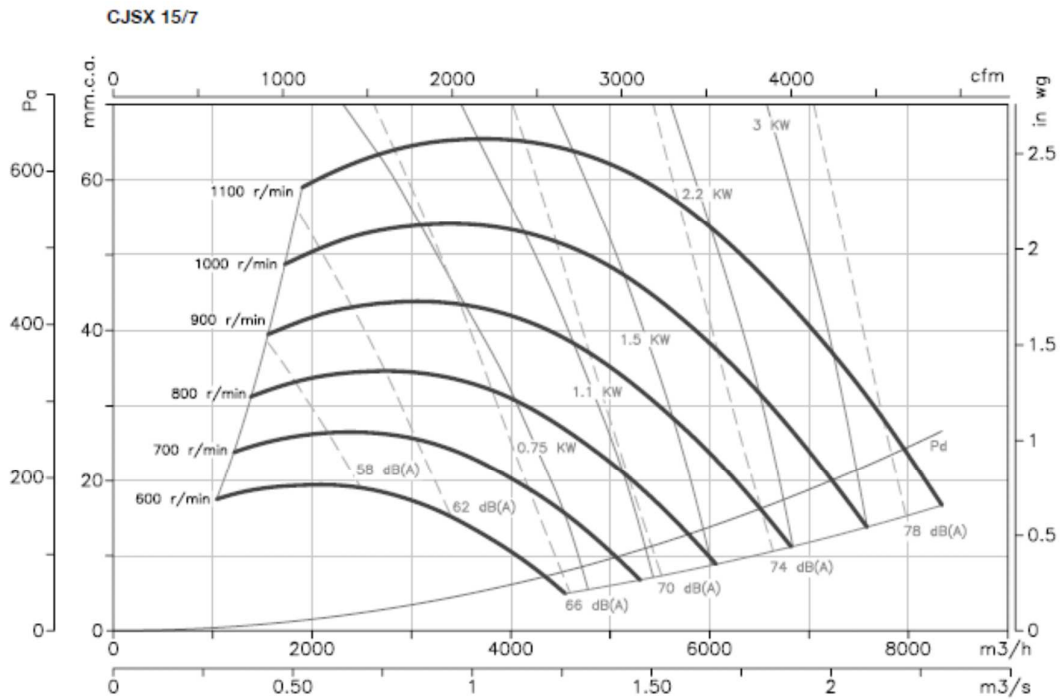
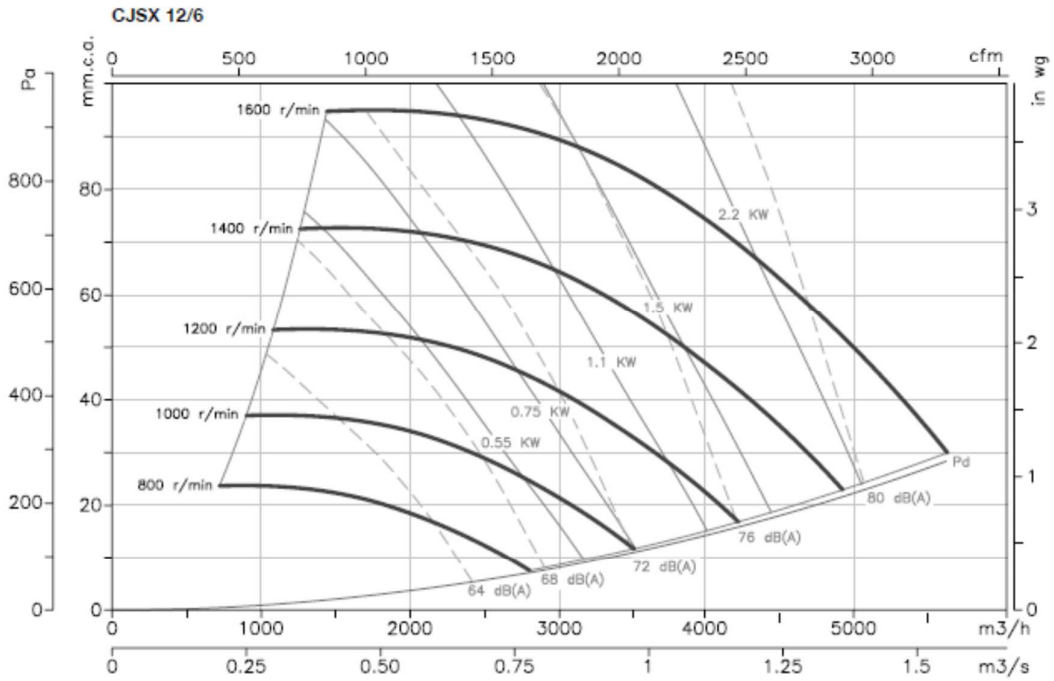

**Curvas características**

Q= Caudal en m<sup>3</sup>/h, m<sup>3</sup>/s y cfm.

Pe= Presión estática en mm.c.a., Pa e in wg.

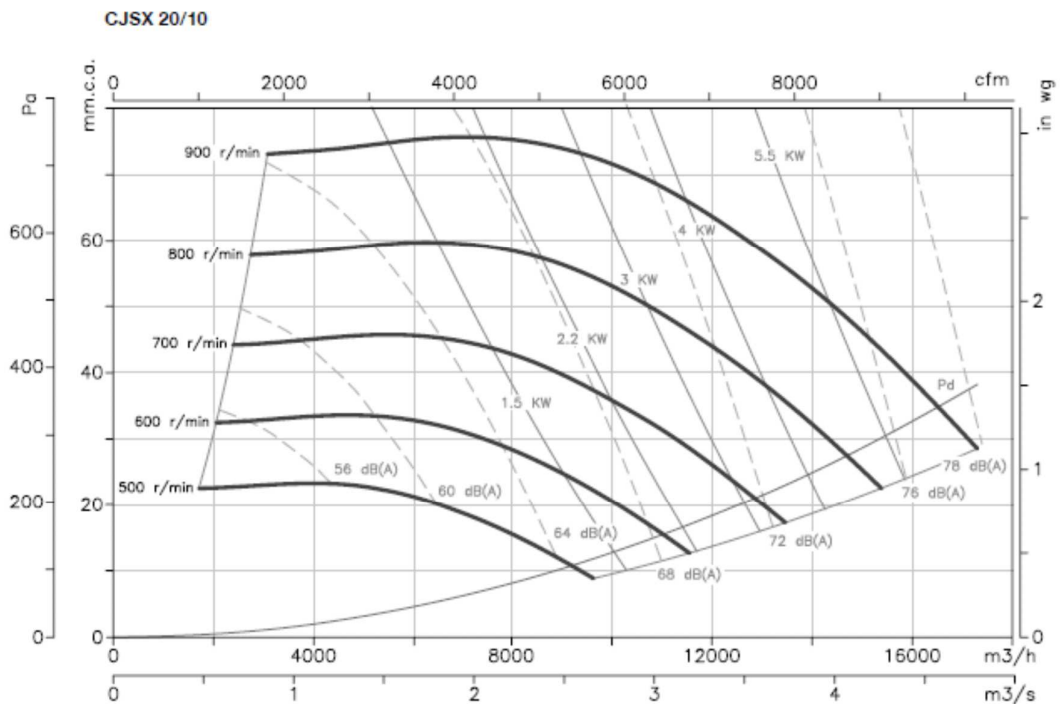
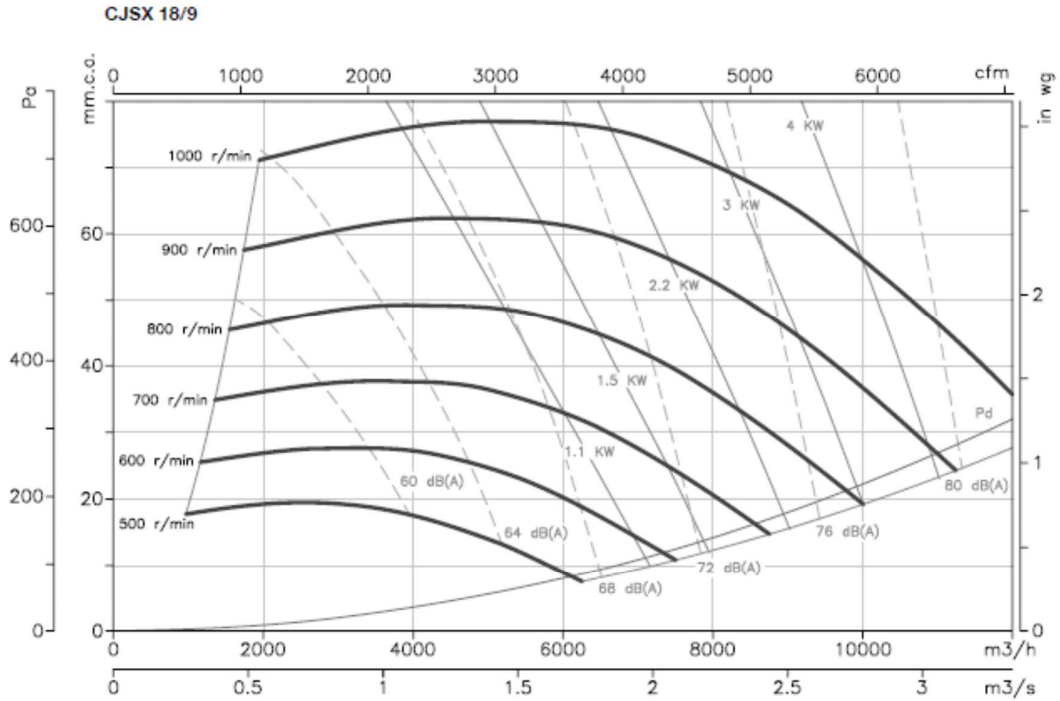

**Curvas características**

Q= Caudal en m³/h, m³/s y cfm.

Pe= Presión estática en mm.c.a., Pa e inwg.

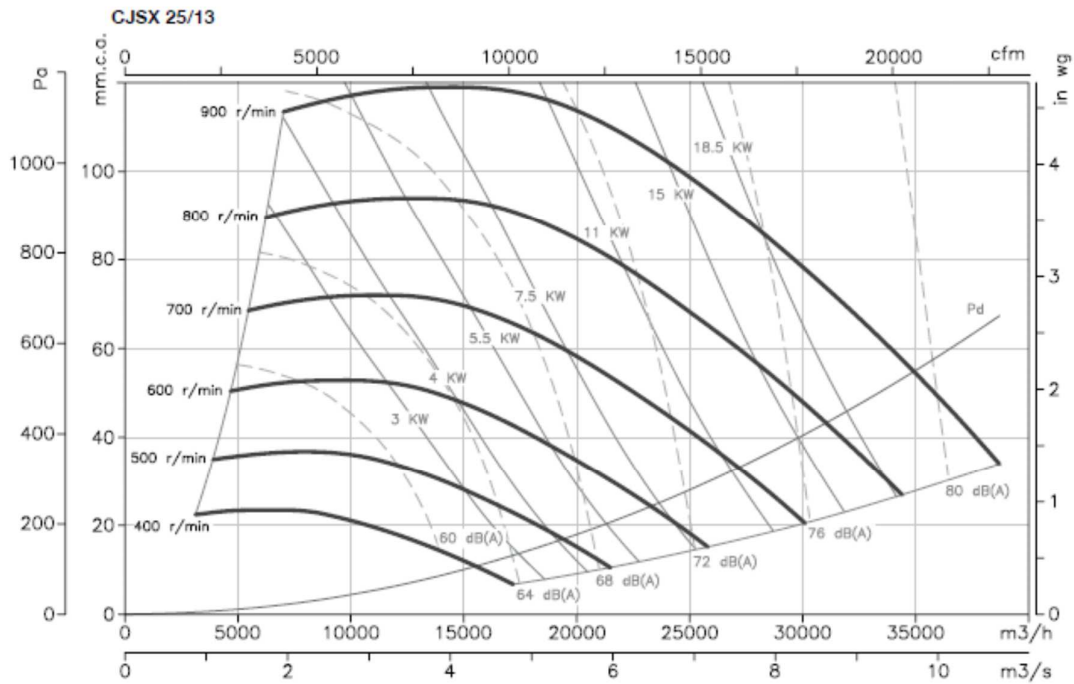
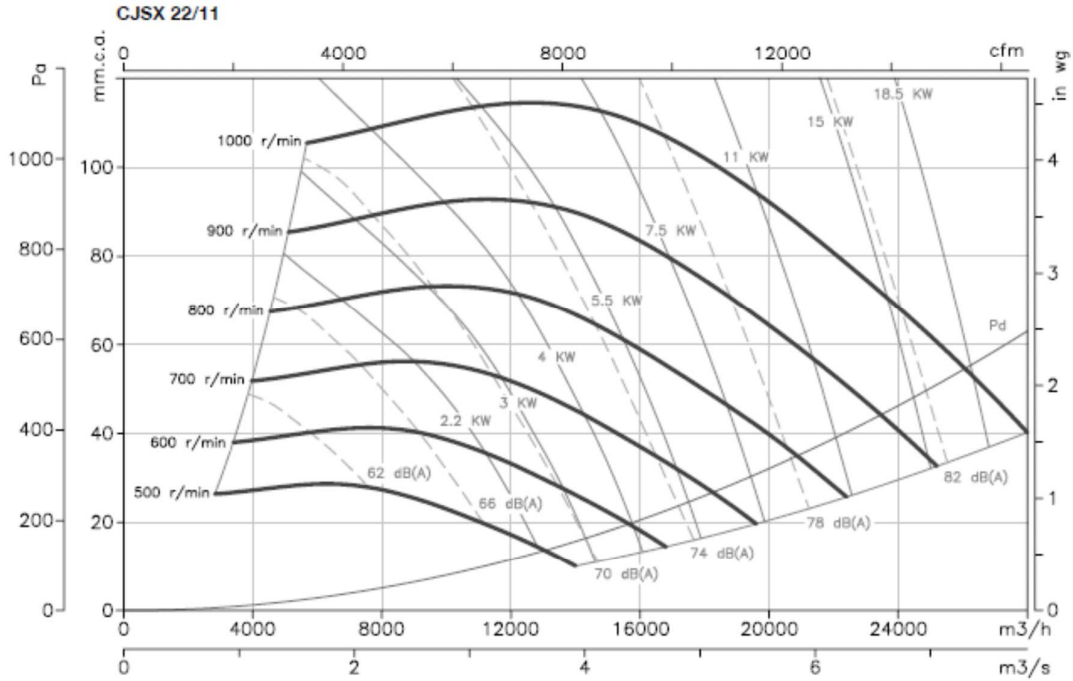

**Curvas características**

Q= Caudal en m<sup>3</sup>/h, m<sup>3</sup>/s y cfm.

Pe= Presión estática en mm.c.a., Pa e inwg.

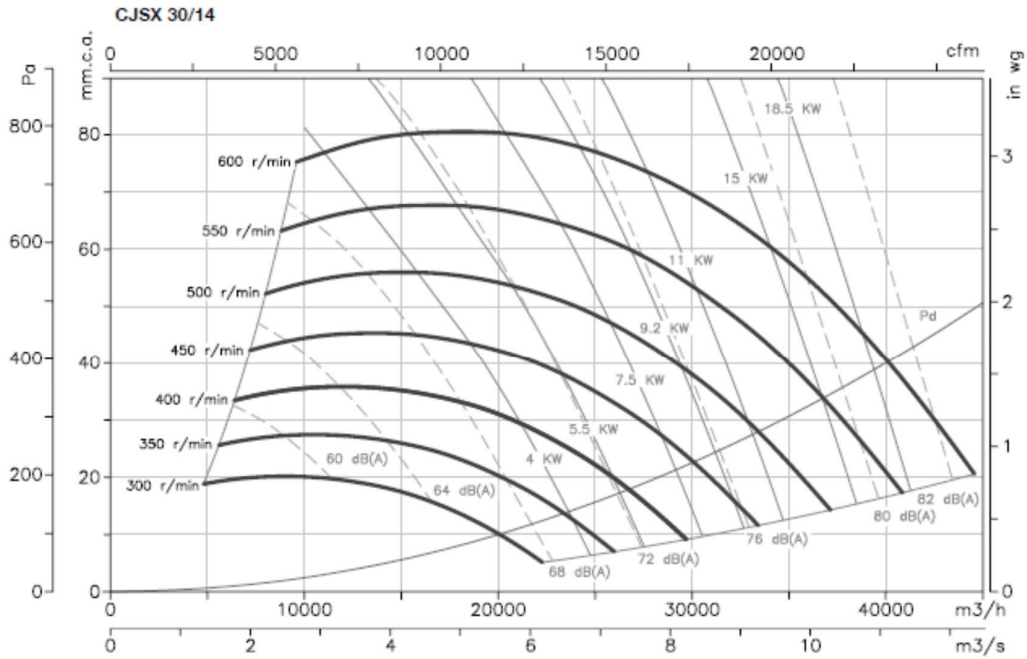

**Accesorios**

Ver apartado accesorios

